

# PROPELLER

MODULAR BENCH SYSTEM



Design: Márk Nagy-Mihály

Year: 2021



## ELEMENTS

PLR-A

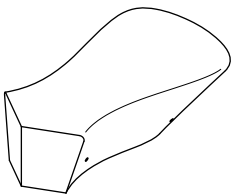

PLR-A-S  
/ with seat

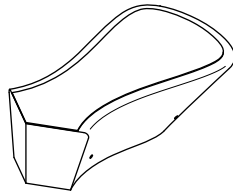

PLR-B

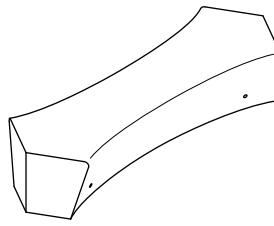

PLR-B-S  
/ with seat

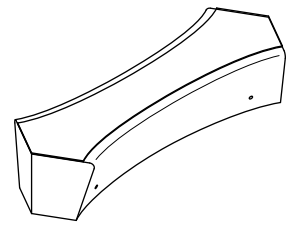

## SAMPLE COMBINATIONS

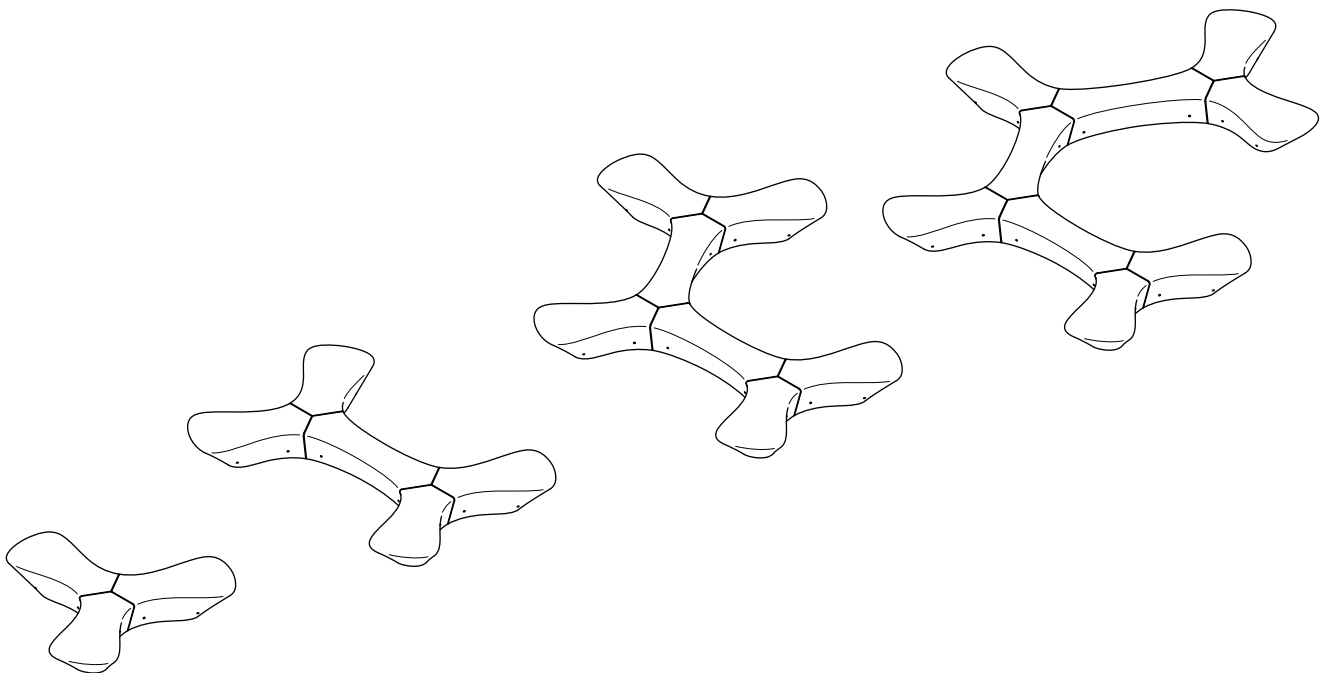

Design: Márk Nagy-Mihály  
Year: 2021

## INFO

Material:	high performance concrete (HPC)
Standard colour:	white
Finish:	natural cast
Treatment:	impregnated
Seat:	HPL
Standard seat colour:	Zinc Yellow
Lifting:	with lifting straps
Placement:	on load-bearing, ready-to-use walking surface
Fixing:	with antifreeze adhesive/ by anchoring
Cleaning:	with neutral detergent

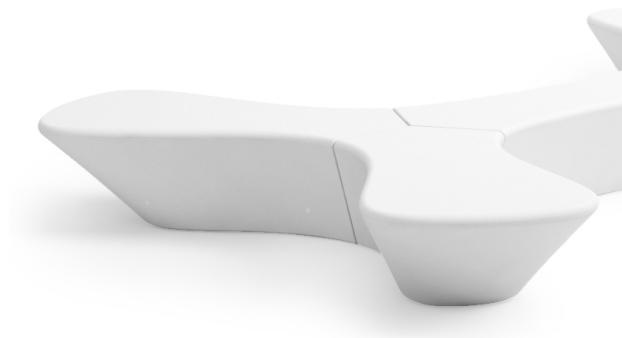

## MEASUREMENTS

0 ——— 500 mm

PRL-A  
760 kg

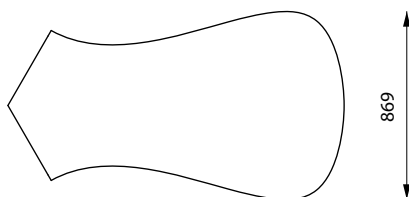
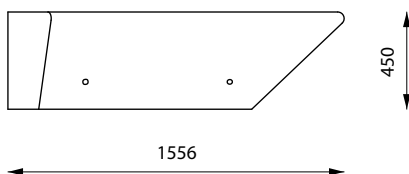

PLR-A-S/ with seat  
770 kg

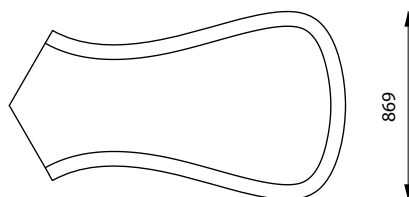
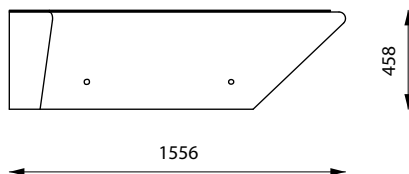

## INSTALLATION

The product may be lifted with lifting straps. The product is fixed with antifreeze adhesive or with anchor bolts to load-bearing walking surface.

For further information see Installation Guide.

## MAINTENANCE

The product may be cleaned with neutral detergent. For further information see Maintenance Guide.

Design: Márk Nagy-Mihály  
Year: 2021

## INFO

Material:	high performance concrete (HPC)
Standard colour:	white
Finish:	natural cast
Treatment:	impregnated
Seat:	HPL
Standard seat colour:	Zinc Yellow
Lifting:	with lifting straps
Placement:	on load-bearing, ready-to-use walking surface
Fixing:	with antifreeze adhesive/ by anchoring
Cleaning:	with neutral detergent



## MEASUREMENTS

0 500 mm

PLR-B  
850 kg

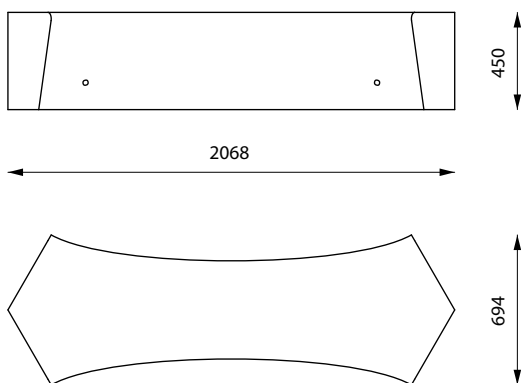

PLR-B-S/ with seat  
860 kg

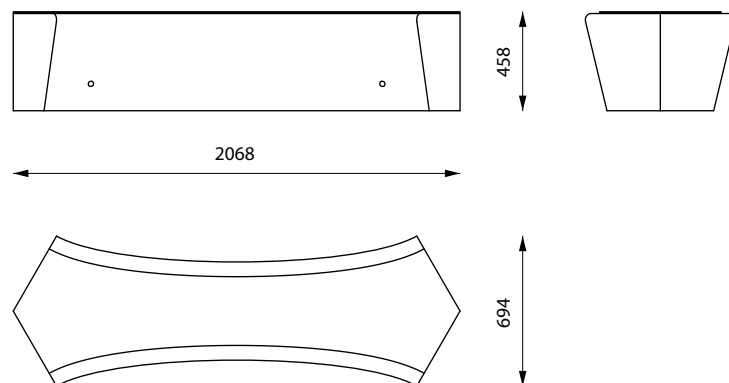

## INSTALLATION

The product may be lifted with lifting straps. The product is fixed with antifreeze adhesive or with anchor bolts to load-bearing walking surface.  
For further information see Installation Guide.

## MAINTENANCE

The product may be cleaned with neutral detergent.  
For further information see Maintenance Guide.